



ANOTHER BEST DAY



Petra **VLHOVA** (SVK)

2021/2022
RACE
PROGRAM



Tessa **WORLEY** (FRA)

BAND OF HEROES

Our Band of Heroes can look back on a winter that will go down in history for Rossignol.

The French brand won the overall standings for the Women's Alpine Skiing and Biathlon World Cup and the Men's Cross-Country Skiing, with a total of 23 Crystal Globes won by 11 athletes in 5 different disciplines (Alpine, Biathlon, Cross-Country, Moguls, Adaptive)!

Moreover, with 55 podium places including 19 victories in alpine skiing, Rossignol has won the World Cup Brand Ranking.

Well done to our athletes and to all those who work alongside them in the shadows!

A SERIE SKIS ATHLÈTES



HERO ATHLETE FIS SL HERO ATHLETE SL

SYSTEM **R22 WC**
 LINE CONTROL TECHNOLOGY (LCT)
 TITANAL CONSTRUCTION
 RECTANGULAR SIDEWALL
 ASH WOOD CORE (165)
 BEECH WOOD CORE (150-157)
 SIDECUT 118/67/104 (165) - 116/66/102 (157) - 115/66/101 (150)
 RADIUS 13 m (165) - 12 m (157) - 11 m (150)
 SIZES 150 - 157 - 165
 WEIGHT (+/- 5 %) 4,2 kg/PAIR (165) - 4,1 kg/PAIR (157) - 4,0 kg/PAIR (150)

| | | | |
|----------------|-----------------------------|----------------|-----------------------------|
| RRJ03AH | 165 | RRKA103 | 157 |
| RAJAH01 | HERO ATHLETE FIS SL (R22) | RAKAI01 | HERO ATHLETE FIS SL (R22) |
| FCIA002 | SPX 15 ROCKERACE GREEN LTD | FCIA006 | SPX 12 ROCKERACE BLACK ICON |
| RRJ01AH | 165 | RRKA104 | 150 |
| RAJAH01 | HERO ATHLETE FIS SL (R22) | RAKAI02 | HERO ATHLETE SL (R22) |
| FCIA005 | SPX 15 ROCKERACE BLACK ICON | FCIA003 | SPX 12 ROCKERACE GREEN LTD |
| RRJ02AH | 165 | RRKA105 | 150 |
| RAJAH01 | HERO ATHLETE FIS SL (R22) | RAKAI02 | HERO ATHLETE SL (R22) |
| FCIA006 | SPX 12 ROCKERACE BLACK ICON | FCIA006 | SPX 12 ROCKERACE BLACK ICON |
| RRKA101 | 157 | RRKA106 | 150 |
| RAKAI01 | HERO ATHLETE FIS SL (R22) | RAKAI02 | HERO ATHLETE SL (R22) |
| FCIA002 | SPX 15 ROCKERACE GREEN LTD | FCHA029 | SPX 12 RACE TEST BLACK ICON |
| RRKA102 | 157 | | |
| RAKAI01 | HERO ATHLETE FIS SL (R22) | | |
| FCIA005 | SPX 15 ROCKERACE BLACK ICON | | |



HERO ATHLETE FIS GS FACTORY
HERO ATHLETE FIS GS
HERO ATHLETE FIS GS DLC

SYSTEM **R22 WC - R22 DLC**
LINE CONTROL TECHNOLOGY (LCT) / DYNAMIC LINE CONTROL (DLC)
TITANAL CONSTRUCTION
RECTANGULAR SIDEWALL
ASH WOOD CORE
SIDE CUT 102/65/84 (193) - 101/65/81 (188)
RADIUS 30 m (193) (FACTORY) - 30 m (188) (FIS GS & FIS GS DLC)
SIZES 193 (FACTORY) - 188 (FIS GS & FIS GS DLC)
WEIGHT (+/- 5 %) 5,2 kg/PAIR (FACTORY) (193)
4,4 kg/PAIR (FIS GS) (188) - 5,9 kg/PAIR (FIS GS DLC) (188)

| | |
|--|--|
| RRKGG01 193 | RRJ04GB 188 |
| RAKGG01 HERO ATHLETE FIS GS FACTORY (R22) | RAIGB03 HERO ATHLETE FIS GS DLC (R22 DLC) |
| FCJA017 PX 18 WC ROCKERACE GREEN LTD | FCJA018 PX 18 WC ROCKERACE BLACK ICON |
| RRKGG02 193 | RRJ04GB 188 |
| RAKGG01 HERO ATHLETE FIS GS FACTORY (R22) | RAIGB03 HERO ATHLETE FIS GS DLC (R22 DLC) |
| FCIA002 SPX 15 ROCKERACE GREEN LTD | FCIA005 SPX 15 ROCKERACE BLACK ICON |
| RRKGH01 188 | |
| RAKGH01 HERO ATHLETE FIS GS (R22) | |
| FCIA005 SPX 15 ROCKERACE BLACK ICON | |
| RRKGH03 188 | |
| RAKGH01 HERO ATHLETE FIS GS (R22) | |
| FCIA002 SPX 15 ROCKERACE GREEN LTD | |
| RRKGH02 188 | |
| RAKGH01 HERO ATHLETE FIS GS (R22) | |
| FCIA006 SPX 12 ROCKERACE BLACK ICON | |

HERO ATHLETE GS

SYSTEM **R22 WC**
LINE CONTROL TECHNOLOGY (LCT)
TITANAL CONSTRUCTION
RECTANGULAR SIDEWALL
BEECH WOOD
SIDE CUT 102-65-84 (185) - 103/65/85 (182) - 102/65/85 (175) - 104/65/87 (170) - 106/65/87 (165)
RADIUS 27 m (185) / 25 m (182) / 23 m (175) / 20 m (170) / 19 m (165)
SIZES 165-170-175-182-185
WEIGHT (+/- 5 %) 4.3 kg/PAIR (185)

| | |
|--|--|
| RRJ01GB 185 | RRJ01DP 165-170-175-182 |
| RAJGB01 HERO ATHLETE GS (R22) | RAJDP01 HERO ATHLETE GS (R22) |
| FCIA005 SPX 15 ROCKERACE BLACK ICON | FCIA006 SPX 12 ROCKERACE BLACK ICON |
| RRJ02GB 185 | RRJ02DP 165-170-175-182 |
| RAJGB01 HERO ATHLETE GS (R22) | RAJDP01 HERO ATHLETE GS (R22) |
| FCIA006 SPX 12 ROCKERACE BLACK ICON | FCHA029 SPX 12 RACE TEST BLACK ICON |
| RRJ05DP 165-170-175-182 | |
| RAJDP01 HERO ATHLETE GS (R22) | |
| FCIA002 SPX 15 ROCKERACE GREEN LTD | |
| RRJ04DP 165-170-175-182 | |
| RAJDP01 HERO ATHLETE GS (R22) | |
| FCIA005 SPX 15 ROCKERACE BLACK ICON | |
| RRJ03DP 165-170-175-182 | |
| RAJDP01 HERO ATHLETE GS (R22) | |
| FCIA003 SPX 12 ROCKERACE GREEN LTD | |

A SKIS
SERIE **ATHLÈTES**



HERO ATHLETE GS PRO
HERO ATHLETE GS OPEN

SYSTEM **R21 PRO / OPEN**

LINE CONTROL TECHNOLOGY - LCT CORE (165)

1/2 TITANAL Fiber (158-151-144 cm) - Ti (165cm)

FIBER (135-130-124 cm)

RECTANGULAR SIDEWALL

POPLAR WOOD CORE - BEECH WOOD CORE (165)

SIDECUT 106/65/87 (165) - 104/65/86 (158) - 102/65/85 (151)
101/64/84 (144) - 102/66/84 (135)
96/64/81 (130) - 93/63/79 (124)

RADIUS 19 m (165) / 18 m (158) / 17 m (151) / 15 m (144)
14 m (135) / 14 m (130) / 13 m (124)

SIZES 135-144-151-158-165 (HERO ATHLETE GS PRO)
124-130-135-144 (HERO ATHLETE GS OPEN)

WEIGHT (+/- 5 %) 3,5 kg/PAIR (165)

| | |
|----------------|---------------------|
| RRJ03DM | 135-144-151-158-165 |
| RAJDM02 | HERO ATHLETE GS PRO |
| FCJA041 | SPX 10 GW B73 |

| | |
|----------------|---------------------|
| RRJ04DM | 135-144-151-158-165 |
| RAJDM02 | HERO ATHLETE GS PRO |
| FCJA044 | NX 10 GW B73 |

| | |
|----------------|---------------------|
| RRJ05DM | 135-144-151-158-165 |
| RAJDM02 | HERO ATHLETE GS PRO |
| FCJA046 | NX 7 GW B73 |

| | |
|----------------|---------------------|
| RRJ06DM | 135-144-151-158-165 |
| RAJDM02 | HERO ATHLETE GS PRO |
| FCJR007 | NX 7 GW RTL B83 |

| | |
|----------------|----------------------|
| RRJ07DM | 124-130-135-144 |
| RAJDM03 | HERO ATHLETE GS OPEN |
| FCJA045 | NX 7 GW LIFTER B73 |

| | |
|----------------|----------------------|
| RRJ09DM | 124-130-135-144 |
| RAJDM03 | HERO ATHLETE GS OPEN |
| FCJR007 | NX 7 GW RTL B83 |

HERO ATHLETE
SL PRO

SYSTEM **R21 PRO**

1/2 TITANAL Fiber (149-142cm)

FIBER (135-128 cm)

RECTANGULAR SIDEWALL

POPLAR WOOD CORE

SIDECUT 115/65/100 (149) - 114/65/99 (142) -
113/65/99 (135) - 112/65/98 (128)

RADIUS 11 m (149) / 10 m (142)
9 m (135) / 8 m (128)

SIZES 128-135-142-149

WEIGHT (+/- 5 %) 3,6 kg/PAIR (149)

| | |
|----------------|---------------------|
| RRJ01AF | 128-135-142-148 |
| RAJAF01 | HERO ATHLETE SL PRO |
| FCJA041 | SPX 10 GW B73 |

| | |
|----------------|---------------------|
| RRJ02AF | 128-135-142-148 |
| RAJAF01 | HERO ATHLETE SL PRO |
| FCJA044 | NX 10 GW B73 |

| | |
|----------------|---------------------|
| RRJ03AF | 128-135-142-148 |
| RAJAF01 | HERO ATHLETE SL PRO |
| FCJA046 | NX 7 GW B73 |

| | |
|----------------|---------------------|
| RRJ04AF | 128-135-142-148 |
| RAJAF01 | HERO ATHLETE SL PRO |
| FCJR007 | NX 7 GW RTL B83 |

HERO ATHLETE
MULTIEVENT

SYSTEM **OPEN**

1/2 TITANAL Fiber

100 % FIBERGLASS

ABS SIDEWALL

FIBER

RECTANGULAR SIDEWALL

POPLAR WOOD CORE

SIDECUT 111/65/97 (127) - 112/65/97 (134)
113/65/98 (141) - 114/65/99(148)

RADIUS 8 m (127) / 9 m (134)
10 m (141) / 11 m (148)

SIZES 127-134-141-148

WEIGHT (+/- 5 %) 2,7 kg/PAIR (148)

| | |
|----------------|-------------------------|
| RRJ01AV | 127-134-141-148 |
| RAJAV01 | HERO ATHLETE MULTIEVENT |
| FCJA045 | NX 7 GW LIFTER B73 |

| | |
|----------------|-------------------------|
| RRJ02AV | 127-134-141-148 |
| RAJAV01 | HERO ATHLETE MULTIEVENT |
| FCJR007 | NX 7 GW RTL B83 |



Michelle **GISIN** (SUI)
Petra **VLHOVA** (SVK)
Katharina **LIENSBERGER** (AUT)



HERO ATHLETE MOGUL ACCELERE HERO MOGUL ACCELERE

SYSTEM **OPEN**

FIBER

RECTANGULAR SIDEWALL

ASH WOOD CORE

SIDECUT

92/63/81 (166-172) - 104-65-86 (158)

RADIUS

26 m (172) / 23 m (166) / 18 m (158)

SIZES

158-166-172

WEIGHT (+/- 5%)

2.8 kg/PAIR (166)



Perrine **LAFFONT** (FRA)
MOGUL WORLD CHAMPION 2019

| | |
|---------|-----------------------------|
| | 166-172 |
| RAJMG01 | HERO ATHLETE MOGUL ACCELERE |
| | 158 |
| RAJDM04 | HERO MOGUL ACCELERE |

M SKIS
SERIE **MASTER**



HERO MASTER DLC

SYSTEM **R22 DLC**
 TITANAL CONSTRUCTION
 DYNAMIC LINE CONTROL (DLC)
 RECTANGULAR SIDEWALL
 ASH WOOD CORE
 SIDECUT 102/65/84
 RADIUS 27 m
 SIZES 185
 WEIGHT (+/- 5 %) 5,8 kg/PAIR

HERO MASTER

SYSTEM **R22 WC**
 TITANAL CONSTRUCTION
 LINE CONTROL TECHNOLOGY (LCT)
 RECTANGULAR SIDEWALL
 ASH WOOD CORE
 SIDECUT 115/70/98 (169) - 115/70/98 (173) - 115/70/97 (179) - 115/71/96 (183)
 RADIUS 15 m (169) - 17 m (173) - 19 m (179) - 21 m (183)
 SIZES 169-173-179-183
 WEIGHT 4,2 kg/PAIR (173)

| |
|---------------------------------|
| RRJ01HE |
| RAHGB03 HERO MASTER DLC |
| FCIA005 SPX 15 ROCKERACE |

| |
|---------------------------------|
| RRJ01HE |
| RAJHE01 HERO MASTER |
| FCIA007 SPX 15 ROCKERACE |

| |
|---------------------------------|
| RRJ02HE |
| RAJHE01 HERO MASTER |
| FCIA006 SPX 12 ROCKERACE |
| RRJ03HE |
| RAJHE01 HERO MASTER |
| FCHA029 SPX 12 RACE TEST |



Petra VLHOVA (SVK)

1 DLC TECHNOLOGY

Used in World Cup by our athletes Tessa Worley and Petra VLHOVA. The DLC technology is a complete hydraulic shock absorber with an attachment point at the front of the ski.

- No Reversed camber !
- Stability during the gates spots (Slapping area with ruts)
- Flex Control during the turns
- Edge Grip efficiency
- Snappy at the end of the turn

Based on Hydraulic Smart System

> HIGHER TRAJECTORY CONTROL



2 LINE CONTROL TECHNOLOGY ENERGY ACTIVATOR

The LCT technology was developed for Racing. The central rail integrated over the entire length of the ski eliminates some of the ski's counter-flexion to ensure stability and dynamic control.

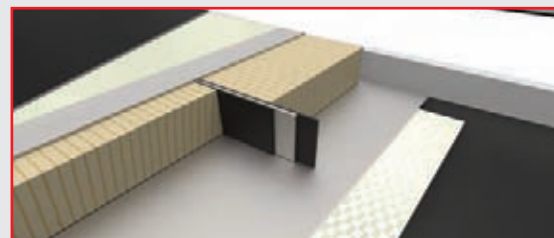

3 RADIUS MASTER

The ski gold standard in the 'Master' category presents a new, more modern approach to turn radius in line with developments in the current technique. With shortened radius on each of the models, the Master is even more playful with more effective turn initiation for greater precision and confidence.

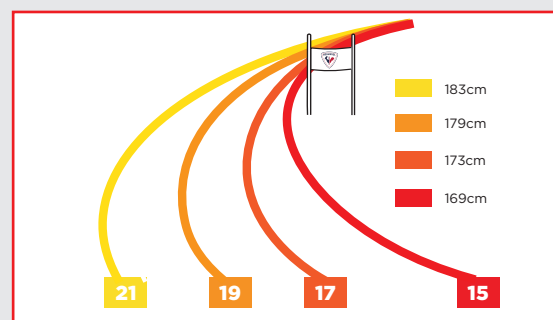

4 DH / SG - R22 PLATE

*SG 203 Approved «U16» & «FIS Ladies»

** for women and lightweight men

More info on: <http://www.fis-ski.com>

| CODE | MODEL | RADIUS | | | | | | |
|---------|------------------------------|--------|-----|------|------|------|------|-----|
| | | 28m | 34m | >40m | >40m | >45m | >50m | |
| | | SIZE | 186 | 196 | 203* | 209 | 212 | 218 |
| RAJYR12 | HERO ATHLETE SG FACTORY | | • | • | | | | |
| RAKY2SG | HERO ATHLETE FIS SG FACTORY | | | | • | | | |
| RAJY1SG | | | | | | • | • | |
| RAJY1DH | HERO ATHLETE FIS DH HARD | | | | | | | • |
| RAJY2DH | HERO ATHLETE FIS DH MEDIUM** | | | | | | | • |

RACE BINDINGS



Green LTD

PX 18 WC ROCKERACE

FCJA017



Green LTD

SPX 15 ROCKERACE

FCIA002



Green LTD

SPX 12 ROCKERACE

FCIA003



Black Icon

PX 18 WC ROCKERACE

FCJA018



Black Icon

SPX 15 ROCKERACE

FCIA005



Forza Master

SPX 15 ROCKERACE

FCIA007



Black Icon

SPX 14 ROCKERACE

FCJA016



Black Icon

SPX 12 ROCKERACE

FCIA006



Black Icon

SPX 12 RACE TEST B80

FCHA029

JUNIOR



Black Icon

SPX 10 GW B73

FCJA041



Black Icon

NX 10 GW B73

FCJA044



Black Icon

NX 7 GW LIFTER B73

FCJA045



Black Icon

NX 7 GW B73

FCJA046



RACING PLATES ENERGY TRANSMISSION

1 R22 WC

The R22 plate has been developed with our World cup athletes.

- Boot soles : 264-352 mm
- Compatible bindings :
PX18, SPX 15, SPX 14, SPX 12 ROCKERACE
- One Piece
- Metal Inserts
- Metal Side wall for a **better grip**
- Weight : 395gr (half pair)

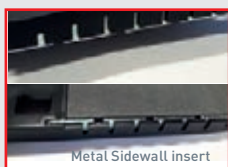

2 R21 PRO

The R21 Pro is the junior version of the R22, developed for young Champions.

- Boot soles : 241-317 mm
- Compatible bindings :
SPX 10 GW, NX 10 GW, NX 7 GW
- Two Pieces
- Composite inserts
- Weight : 190gr (half pair)



| CODE | NAME | COLOUR | Z | TOE PIECE | | | HEEL PIECE | | | BINDING WEIGHT 1/2 PAIR +/-15g | COMPATIBLE BOOTS SOLE TYPES | | | | LENGTH ADJUSTMENT | HEIGHT | | INCLUDED PARTS |
|--------------------------|--------------------|--------------|--------|-------------|------|--------------------|------------|-----------|----------------------|-----------------------------------|--------------------------------|--------------|----------------------------|-------------|----------------------|---------|---------|--------------------|
| | | | | TYPE | BASE | AFD TYPE | TYPE | BASE | BRAKE / SKI WAIST | | ISO 5355 "A" | ISO 5355 "C" | GRIP WALK | PIN INSERTS | | TOE | HEEL | |
| RACE | | | | | | | | | | | | | WITH R22 PLATES | | | | | |
| FCJA017 | PX 18 WC Rockerace | Green Ltd | 10-18 | Race | | Race AFD | PX WC ALU | Rockerace | <80 mm | 1635 g | • | | | | 20 mm | 27,6 mm | 31,2 mm | Lifters |
| FCIA002 | SPX 15 Rockerace | Green Ltd | 7-15 | Race | | Race AFD | SPX Micro | Rockerace | <80 mm | 1295 g | • | | | | 20 mm | 27,6 mm | 31,2 mm | |
| FCIA003 | SPX 12 Rockerace | Green Ltd | 3,5-12 | Full Action | | Full Action GW AFD | SPX Micro | Rockerace | <80 mm | 1130 g | • | | | | 20 mm | 30,5 mm | 31,2 mm | |
| FCJA018 | PX 18 WC Rockerace | Black Icon | 10-18 | Race | | Race AFD | PX WC ALU | Rockerace | <80 mm | 1635 g | • | | | | 20 mm | 27,6 mm | 31,2 mm | Lifters |
| FCIA005 | SPX 15 Rockerace | Black Icon | 7-15 | Race | | Race AFD | SPX Micro | Rockerace | <80 mm | 1295 g | • | | | | 20 mm | 27,6 mm | 31,2 mm | |
| FCJA016 | SPX 14 Rockerace | Black Icon | 5-14 | Full Action | | Full Action GW AFD | SPX Micro | Rockerace | <80 mm | 1130 g | • | | | | 20 mm | 30,5 mm | 31,2 mm | |
| FCIA006 | SPX 12 Rockerace | Black Icon | 3,5-12 | Full Action | | Full Action GW AFD | SPX Micro | Rockerace | <80 mm | 1130 g | • | | | | 20 mm | 30,5 mm | 31,2 mm | |
| FCIA007 | SPX 15 Rockerace | Forza Master | 7-15 | Race | | Race AFD | SPX Micro | Rockerace | <80 mm | 1295 g | • | | | | 20 mm | 27,6 mm | 31,6 mm | |
| FCHA029 | SPX 12 Race Test | Black Icon | 3,5-12 | Full Action | | Full Action GW AFD | SPX | 3P | < 80 mm | 1080 g | • | | | | 45 mm | 30,5 mm | 30,6 mm | |
| JUNIOR A LA CARTE | | | | | | | | | | | | | | | | | | |
| FCJA041 | SPX 10 GW B73 | Black Icon | 3-10 | FDC | | FDC GW AFD | SPX | 2P | < 73 mm | 900 g | • | | • | | 24 mm | 14 mm | 16 mm | |
| FCJA044 | NX 10 GW B73 | Black Icon | 3-10 | FDC | | FDC GW AFD | NX | 2P | < 73 mm | 795 g | • | | • | | 24 mm | 14 mm | 16 mm | |
| FCJA045 | NX 7 GW Lifter B73 | Black Icon | 2-7 | FDC | | FDC GW AFD | NX | 2P | < 73 mm | 880 g | • | spare part | • | | 24 mm | 24 mm | 26 mm | Adult G1 Screw Kit |
| FCJA046 | NX 7 GW B73 | Black Icon | 2-7 | FDC | | FDC GW AFD | NX | 2P | < 73 mm | 765 g | • | spare part | • | | 24 mm | 14 mm | 16 mm | Adult G1 Screw Kit |

1 DUAL CORE TECHNOLOGY

The entire HERO WORLD CUP and HERO range features the **DUAL CORE** technology. The DUAL CORE technology involves injecting materials with different hardness levels into the same mould, with **three injection points in the shell and two injection points in the cuff**. The result is a sandwich construction with an ultra-thin layer of hard materials on the outside encapsulating the softer materials inside.

This technology can be used to accurately fine-tune the progressive flex, rear support and rebound. It also allows for highly effective lateral power transfer.



2 PRE-SHAPED ANATOMICAL LINERS

The lower part of these liners is pre-shaped around the ankle bone to ensure a snug fit with the shell's internal last. The shape can be seen on the outside of the liner.



Henrik **KRISTOFFERSEN** (NOR)
GS WORLD CHAMPION 2019

RACE HERO



DUAL CORE

HERO WORLD CUP ZC/ZB/ZA

92
mm

| | |
|----------------------|-----------------------------|
| LAST | 92 |
| WEIGHT KG (1/2 PAIR) | 2,450 |
| TECHNOLOGY | DUAL CORE |
| SHELL | POLYETHER |
| CUFF | POLYETHER |
| LINER | WORLD CUP RACING FIT |
| HEEL PIECES | FIS NORMS Need to be ground |

| | |
|----------------|---|
| RBJ9240 | ZC - WHITE 23.5 - 29.5 MSS (FULL SIZES) |
| RBJ9250 | ZB - WHITE 22.5 - 29.5 MSS (FULL SIZES) |
| RBJ9260 | ZA - WHITE 22.5 - 29.5 MSS (FULL SIZES) |

JUNIOR HERO



FULL CUSTOM LINER

DUAL CORE

HERO WORLD CUP 110 SC

97
mm

| | |
|----------------------|----------------------------------|
| LAST | 97 |
| FLEX | 110 |
| WEIGHT KG (1/2 PAIR) | 1,990 |
| TECHNOLOGY | DUAL CORE |
| SHELL | POLYURETHANE |
| CUFF | POLYURETHANE |
| SPECIFICATIONS | SHORT CUFF |
| LINER | PRE-SHAPE LINER - FULL CUSTOM T2 |

| | |
|----------------|-------------------|
| RBJ9010 | WHITE / 21 - 28.5 |
|----------------|-------------------|



DUAL CORE

HERO WORLD CUP ZA+ /ZJ+

92+
mm

| | |
|----------------------|----------------------|
| LAST | 92 PLUS |
| WEIGHT KG (1/2 PAIR) | 2,430 |
| TECHNOLOGY | DUAL CORE |
| SHELL | POLYETHER |
| CUFF | POLYETHER |
| LINER | WORLD CUP RACING FIT |
| HEEL PIECES | GROUND SOLES |

RBJ9270 ZA + - WHITE 22.5 - 28.5 MSS (FULL SIZES)

RBJ9280 ZJ + - WHITE 22.5 - 28.5 MSS (FULL SIZES)



DUAL CORE

HERO WORLD CUP Z SOFT+

92+
mm

| | |
|----------------------|----------------------|
| LAST | 92 PLUS |
| WEIGHT KG (1/2 PAIR) | 2,360 |
| TECHNOLOGY | DUAL CORE |
| SHELL | POLYETHER |
| CUFF | POLYETHER |
| LINER | WORLD CUP RACING FIT |
| HEEL PIECES | GROUND SOLES |

RBK9300 Z SOFT + - WHITE 22.5 - 28.5 MSS (FULL SIZES)



FULL
CUSTOM
LINER

DUAL CORE

HERO WORLD CUP 140

97
mm

| | |
|----------------------|----------------------------------|
| LAST | 97 |
| FLEX | 140 |
| WEIGHT KG (1/2 PAIR) | 2,250 |
| TECHNOLOGY | DUAL CORE |
| SHELL | POLYETHER |
| CUFF | POLYETHER |
| LINER | PRE-SHAPE LINER - FULL CUSTOM T1 |

RBJ1010 WHITE / 24 - 30.5



FULL
CUSTOM
LINER

DUAL CORE

HERO WORLD CUP 90 SC

97
mm

| | |
|----------------------|----------------|
| LAST | 97 |
| FLEX | 90 |
| WEIGHT KG (1/2 PAIR) | 1,980 |
| TECHNOLOGY | DUAL CORE |
| SHELL | POLYURETHANE |
| CUFF | POLYURETHANE |
| SPECIFICATIONS | SHORT CUFF |
| LINER | FULL CUSTOM T2 |

RBJ9050 WHITE / 21 - 28.5



FULL
CUSTOM
LINER

DUAL CORE

HERO WORLD CUP 70 SC

97
mm

| | |
|----------------------|----------------|
| LAST | 97 |
| FLEX | 70 |
| WEIGHT KG (1/2 PAIR) | 1,880 |
| TECHNOLOGY | DUAL CORE |
| SHELL | POLYURETHANE |
| CUFF | POLYOLEFINE |
| SPECIFICATIONS | SHORT CUFF |
| LINER | FULL CUSTOM T3 |

RBJ9070 WHITE / 21 - 28.5

RACE HELMETS



HOT RED RKHH104



HERO CARBON FIBER FIS

| | |
|----------------------|-----------------------------|
| SIZES | 54 - 56 - 58 - 60 - 61+ |
| WEIGHT | 530 g |
| CERTIFICATION | CE EN1077 & ASTM 2040 & FIS |
| CONSTRUCTION | HARDHELL - CARBON SHELL |
| CHINGUARD COMPATIBLE | |

PINK/WHITE RKHH105



IMPACTS

HOT RED / BLACK RKHH100



HERO 9 FIS IMPACTS (WITH CHINGUARD)

| | |
|--------------------|-----------------------------|
| SIZES | 54 - 56 - 58 - 60 - 61+ |
| WEIGHT | 580 g |
| CERTIFICATION | CE EN1077 & ASTM 2040 & FIS |
| CONSTRUCTION | HARDSHELL - ABS SHELL |
| CHINGUARD INCLUDED | |



IMPACTS

BLACK / HOT RED RKIH100



HERO TEMPLAR SL IMPACTS (WITH CHINGUARD)

| | |
|--------------------|--|
| SIZES | S/M (52-55) , M/L (55-59) , L/XL (59-63) |
| WEIGHT | 490 g |
| CERTIFICATION | CE EN1077 & ASTM 2040 |
| CONSTRUCTION | HARDSHELL - ABS SHELL |
| VENTILATION | PERMANENT |
| CHINGUARD INCLUDED | |



IMPACTS

BLACK RKKH100



ROOSTER FIS IMPACTS

| | |
|----------------------|-----------------------------|
| SIZES | 54 - 56 - 58 - 60 - 61+ |
| WEIGHT | 580 g |
| CERTIFICATION | CE EN1077 & ASTM 2040 & FIS |
| CONSTRUCTION | HARDSHELL - ABS SHELL |
| CHINGUARD COMPATIBLE | |



IMPACTS

BLACK RKHH103



HERO 7 FIS IMPACTS

| | |
|----------------------|-----------------------------|
| SIZES | 56 - 58 - 60 - 61+ |
| WEIGHT | 580 g |
| CERTIFICATION | CE EN1077 & ASTM 2040 & FIS |
| CONSTRUCTION | HARDSHELL - ABS SHELL |
| CHINGUARD COMPATIBLE | |

PINK RKJH501



IMPACTS

HOT RED RKJH502



HERO KIDS IMPACTS

| | |
|----------------------|-----------------------|
| SIZES | XS (49-53) |
| WEIGHT | 540 g |
| CERTIFICATION | CE EN1077 & ASTM 2040 |
| CONSTRUCTION | HARDSHELL - ABS SHELL |
| CHINGUARD COMPATIBLE | |

CHINPROTEC SL (FOR HERO SL)

| | |
|------------|-------------------------|
| COMPATIBLE | HERO TEMPLAR SL IMPACTS |
|------------|-------------------------|

RKCC100



CHINPROTEC DH (FOR HERO)

| | |
|------------|--|
| COMPATIBLE | HERO JR FIS IMPACTS / HERO CARBON FIBER FIS HERO 9 FIS IMPACTS / HERO 7 FIS IMPACTS |
|------------|--|

RKCC105





IMPACTS PROTECTS YOU LONGER

BENEFITS

MULTI-IMPACTS TECHNOLOGY

RELIABLE
& DURABLE
SOLUTION

IMPROVED
PROTECTION

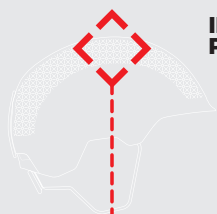

STANDARD
TECHNOLOGY

IMPACTS
TECHNOLOGY

BEFORE



DURING



AFTER

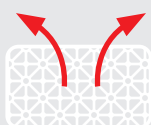

FEDERICA BRIGNONE (ITA)

RACE GOGGLES

HERO BLACK

| | |
|-----------|--------------------|
| LENS TYPE | SINGLE |
| LENS FORM | CYLINDRICAL |
| FOAM | DOUBLE WITH FLEECE |
| STRAP | SILICONE |



RKHG100



ACE HERO

| | |
|-----------|--------------------|
| LENS TYPE | DOUBLE |
| LENS FORM | SPHERICAL |
| FOAM | SINGLE WITH FLEECE |
| STRAP | SILICONE |



RKHG101

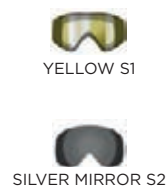

ACE HERO W

| | |
|-----------|--------------------|
| LENS TYPE | DOUBLE |
| LENS FORM | SPHERICAL |
| FOAM | SINGLE WITH FLEECE |
| STRAP | SILICONE |



RKHG102



RAFFISH HERO

| | |
|-----------|--------------------|
| LENS TYPE | SIMPLE |
| LENS FORM | CYLINDRICAL |
| FOAM | SINGLE WITH FLEECE |
| STRAP | SILICONE |
| AGE | 6-12 YEARS |



RKHG500

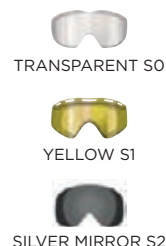

RACE POLES



HOT RED
RD11010

HERO CAK GO GREEN

| | | | |
|----------|--------------------------|--------|-----------|
| DIAMETER | 16 mm | TIP | CARBIDE |
| GRIP | HERO | WEIGHT | 250 g |
| STRAP | HERO VELCRO | SIZE | 115-135/5 |
| BASKET | WORLD CUP & RACE - 54 mm | | |



HOT RED
RDH1000

HERO CARBON

| | | | |
|----------|--------------|--------|-----------|
| DIAMÈTRE | 12,7 mm | TIP | CARBIDE |
| POIGNÉE | HERO | WEIGHT | 260 g |
| DRAGONNE | HERO VELCRO | SIZE | 115-135/5 |
| RONDELLE | RACE - 54 mm | | |



HOT RED
RDH1010

HERO GS/SG

| | | | |
|----------|-------------------|-------------|-------------------|
| DIAMETER | 18 mm | TIP | CARBIDE |
| GRIP | HERO | WEIGHT | 240 g |
| STRAP | HERO VELCRO | SIZE | 115-140/5 |
| BASKET | WORLD CUP - 54 mm | SPECIFICITY | TRIANGULAR PROFIL |



HOT RED
RD11000

HERO GS

| | | | |
|----------|-------------------|-------------|-------------------|
| DIAMETER | 18 mm | TIP | CARBIDE |
| GRIP | HERO | WEIGHT | 240 g |
| STRAP | HERO VELCRO | SIZE | 115-140/5 |
| RONDELLE | WORLD CUP - 54 mm | SPECIFICITY | TRIANGULAR PROFIL |



HOT RED
RDH1020

HERO SL

| | | | |
|----------|--------------|-------------|-------------------|
| DIAMETER | 18 mm | TIP | CARBIDE |
| GRIP | HERO | WEIGHT | 245 g |
| STRAP | HERO VELCRO | SIZE | 115-140/5 |
| BASKET | RACE - 54 mm | SPECIFICITY | TRIANGULAR PROFIL |



RACE JUNIOR POLES



HOT RED
RDH6000

HERO GS-SG Jr

| | | | |
|----------|-------------------|-------------|-------------------|
| DIAMETER | 16 mm | TIP | CARBIDE |
| GRIP | WORLD CUP JUNIOR | WEIGHT | 180 g |
| STRAP | REGULAR JUNIOR | SIZE | 90-115/5 |
| BASKET | WORLD CUP - 54 MM | SPECIFICITY | TRIANGULAR PROFIL |



HOT RED
RDH6010

HERO SL Jr

| | | | |
|----------|------------------|-------------|-------------------|
| DIAMETER | 16 mm | TIP | CARBIDE |
| GRIP | WORLD CUP JUNIOR | WEIGHT | 180 g |
| STRAP | REGULAR JUNIOR | SIZE | 90-115/5 |
| BASKET | COURSE - 51 MM | SPECIFICITY | TRIANGULAR PROFIL |





RACE PROTECTIONS

RPG IN&MOTION AIRBAG VEST

Officially approved by the International Ski Federation in June 2015, the In&motion smart wearable airbag has been developed in close partnership with top professional skiers, traumatologists and Rossignol group Athletes, with the goal to increase protection without compromising comfort nor performances. Used in Alpine and Skicross World Cup by racers from 7 different nations with dozens of successful activations, In&motion technology in partnership with Rossignol Protective Gear is the first smart wearable airbag available to public.

| | |
|---------------|---------------------------------------|
| SIZES | S/M - M/L - L/XL |
| WEIGHT | 1740 g |
| CERTIFICATION | CE (EN1621-2:2014) |
| TECHNOLOGY | SAS TECH + IN&MOTION |
| FABRICS | MESH & STRETCH FABRICS |
| FIT | ZIP VEST - REMOVABLE VELCRO WAISTBELT |

RKGP100



NOT INFLATED



INFLATED



WOMEN JUNIOR



JUNIOR



RPG VEST SR - SAS TEC

| | |
|---------------|---|
| SIZES | S/M - M/L - L/XL (UNISEX) S/M - M/L (WOMEN) XXS - XS/S (JUNIOR) |
| WEIGHT | 550 g (UNISEX) |
| CERTIFICATION | CE (EN1621-2:2014) |
| TECHNOLOGY | SAS-TEC INSERT |
| FABRICS | MESH & STRETCH FABRICS |
| FIT | ZIP VEST - REMOVABLE VELCRO WAISTBELT |

RKFP200

UNISEX

RKFP400

WOMEN

RKFP500

JUNIOR

RPG STRAP SR - SAS TEC

| | |
|---------------|--|
| SIZES | S/M - M/L - L/XL (UNISEX) XXS - XS/S (JUNIOR) |
| WEIGHT | 350 g |
| CERTIFICATION | CE (EN1621-2:2014) |
| TECHNOLOGY | SAS-TEC INSERT |
| FABRICS | MESH & STRETCH FABRICS |
| FIT | REMOVABLE VELCRO WAISTBELT |

RKFP201

UNISEX

RKFP501

JUNIOR

RPG SHORTS

| | |
|---------------|-----------------------------------|
| SIZES | S - M - L - XL JR : XXS - XS/S |
| WEIGHT | 350 g |
| CERTIFICATION | CE (EN1621-2:2014) |
| TECHNOLOGY | EVA MULTI DENSITY |
| FABRICS | STRETCH FABRICS |
| FIT | REMOVABLE VELCRO WAISTBELT |

RKFP202



INTEGRAL HAND PROTECTION

| | |
|---------|-----------|
| SIZES | TU |
| WEIGHT | 400 g |
| FABRICS | POLYAMIDE |

RKJP102

HOT RED



HERO LEG PROTECTION SR & JR

| | | |
|---------|------------------------------------|--------|
| SIZES | M / L (SR) | S (JR) |
| WEIGHT | 600 g | 500 g |
| FABRICS | POLYAMIDE | |
| FIT | BI DENSITY FOAM & ADJUSTABLE STRAP | |

RKJP100

HOT RED (SENIOR)

RKJP101

HOT RED (JUNIOR)



HERO FOREARM PROTECTION SR & JR

| | | |
|---------|---------------------------------|------------|
| SIZES | TU | TU |
| WEIGHT | 300 g (SR) | 200 g (JR) |
| FABRICS | POLYAMIDE | |
| FIT | BI DENSITY FOAM & ELASTIC STRAP | |

RKJP103

HOT RED (SENIOR)

RKJP104

HOT RED (JUNIOR)



RACE BAGS

Rossignol's range of technical backpacks offers specific functionalities, carrying and storage options. From a simple hydration pack to a snow shovel, a pair of skis or our latest splitboard, there is space for all your equipment. Different volumes and technical levels are available to suit each individual's needs and practice.



Loïc Meillard (SUI)



HERO SKI WHEELED 2/3P 210

| | |
|-----------|--------------------|
| TYPE | SKI BAG |
| VOLUME | 3 PAIRS / 210 CM |
| DIMENSION | L2150*W360*H225 mm |
| WEIGHT | 5,71 kg |

RKHB106



HERO SKI BAG 4P 230

| | |
|-----------|--------------------|
| TYPE | SKI BAG |
| VOLUME | 4 PAIRS / 230 CM |
| DIMENSION | L2320*W390*H100 mm |
| WEIGHT | 3.50 kg |

RKHB107



HERO JUNIOR SKI BAG 170CM

| | |
|-----------|--------------------|
| TYPE | SKI BAG |
| VOLUME | 1 PAIR / 170 CM |
| DIMENSION | L1700*W210*H210 mm |
| WEIGHT | 1,46 kg |

RKHB104



HERO SKI BAG 2/3P ADJUSTABLE 190/220

| | |
|-----------|-------------------------|
| TYPE | SKI BAG |
| VOLUME | 3 PAIRS / 190 TO 220 CM |
| DIMENSION | L1900/2200*W300*H250 mm |
| WEIGHT | 1.46 kg |

RKHB105



HERO PRO SEAT

| | |
|-----------|-------------------|
| TYPE | EQUIPMENT BAG |
| VOLUME | 55 L |
| DIMENSION | L500*W340*H320 mm |
| WEIGHT | 2,30 kg |

RKHB102



HERO BOOT PRO

| | |
|-----------|-------------------|
| TYPE | BOOT BAG |
| VOLUME | 75 L |
| DIMENSION | L450*W280*H600 mm |
| WEIGHT | 1,40 kg |

RKHB103



HERO BOOT PACK

| | |
|-----------|-------------------|
| TYPE | EQUIPMENT BAG |
| VOLUME | 36 L |
| DIMENSION | L290*W140*H610 mm |
| WEIGHT | 1,40 kg |

RKHB101



HERO ATHLETES BAG

| | |
|-----------|-------------------|
| TYPE | EQUIPMENT BAG |
| VOLUME | 95 L |
| DIMENSION | L490*W280*H700 mm |
| WEIGHT | 2 kg |

RKHB113



HERO SMALL ATHLETES BAG

| | |
|-----------|-------------------|
| TYPE | EQUIPMENT BAG |
| VOLUME | 75 L |
| DIMENSION | L360*W380*H600 mm |
| WEIGHT | 1,30 kg |

RKKB100



HERO CABIN BAG

| | |
|-----------|-------------------|
| TYPE | TRAVEL BAG |
| VOLUME | 50 L |
| DIMENSION | L520*W320*H300 mm |
| WEIGHT | 2,82 kg |

RKHB109



HERO EXPLORER

| | |
|-----------|-------------------|
| TYPE | TRAVEL BAG |
| VOLUME | 125L |
| DIMENSION | L790*W390*H450 mm |
| WEIGHT | 4,64 kg |

RKHB110



HERO HEATED BAG 110V

| | |
|-----------|-------------------|
| TYPE | EQUIPMENT BAG |
| VOLUME | 60 L |
| DIMENSION | L460*W430*H340 mm |
| WEIGHT | 4,64 kg |

RKHB112

110 V

RKHB111

220 V



HERO DUAL BOOT BAG

| | |
|-----------|-------------------|
| TYPE | BOOT BAG |
| VOLUME | 19 L |
| DIMENSION | L490*W360*H110 mm |
| WEIGHT | 0,75 kg |

RKHB108

COACH CORNER



LONG SHELL

RLJS05A S / M / L / XL / XXL



COACH PANTS

RLIS521 XXS / XS / S / M / L / XL / XXL

HERO ELITE ST Ti (R22) SHORT TURN

SYSTEM R22

LINE CONTROL TECHNOLOGY
TITANAL CONSTRUCTION
RECTANGULAR SIDEWALL
ASH WOOD CORE

| | |
|-----------------|--|
| SIDECUT | 122/68/104 |
| RADIUS | 14 m (172) / 13 m (167) 12 m (162) / 11 m (157) |
| SIZES | 157-162-167-172 |
| WEIGHT (+/- 5%) | 4,1 kg/PAIR (167) |

| | |
|---------|------------------------|
| RRJ01LX | |
| RAJLX01 | HERO ELITE ST Ti (R22) |
| FCJA016 | SPX 14 ROCKERACE |

| | |
|---------|------------------------|
| RRJ02LX | |
| RAJLX01 | HERO ELITE ST Ti (R22) |
| FCHA029 | SPX 12 RACE TEST |

| | |
|---------|----------------------------|
| RRJ07LX | |
| RAJLX01 | HERO ELITE ST Ti (R22) |
| FCIA002 | SPX 15 ROCKERACE GREEN LTD |

| | |
|---------|----------------------------|
| RRJ08LX | |
| RAJLX01 | HERO ELITE ST Ti (R22) |
| FCIA003 | SPX 12 ROCKERACE GREEN LTD |

HERO ELITE ST Ti SHORT TURN

SYSTEM KONECT

LINE CONTROL TECHNOLOGY
TITANAL CONSTRUCTION
RECTANGULAR SIDEWALL
ASH WOOD CORE

| | |
|-----------------|--|
| SIDECUT | 122/68/104 |
| RADIUS | 14 m (172) / 13 m (167) 12 m (162) / 11 m (157) |
| SIZES | 157-162-167-172 |
| WEIGHT (+/- 5%) | 3,9 kg/PAIR (167) |

| | |
|---------|---------------------------|
| RRJ03LX | |
| RAJLX02 | HERO ELITE ST Ti (KONECT) |
| FCJC001 | SPX 14 KONECT GW B80 |

| | |
|---------|---------------------------|
| RRJ04LX | |
| RAJLX02 | HERO ELITE ST Ti (KONECT) |
| FCIC025 | NX 12 KONECT GW B80 |



FULL CUSTOM LINER
DUAL CORE

100 mm



FULL CUSTOM LINER
DUAL CORE

97 mm

HERO WORLD CUP 130 MEDIUM

| | |
|----------------------|----------------------------------|
| LAST | 100 |
| FLEX | 130 |
| WEIGHT KG (1/2 PAIR) | 2,250 |
| TECHNOLOGY | DUAL CORE |
| SHELL | POLYETHER |
| CUFF | POLYETHER |
| LINER | PRE-SHAPE LINER - FULL CUSTOM T1 |
| HEEL PIECES | GRIPWALK COMPATIBLE |

RBJ1020 WHITE / 24 - 31.5

HERO WORLD CUP 120

| | |
|----------------------|----------------------------------|
| LAST | 97 |
| FLEX | 120 |
| WEIGHT KG (1/2 PAIR) | 2,260 |
| TECHNOLOGY | DUAL CORE |
| SHELL | POLYETHER |
| CUFF | POLYETHER |
| LINER | PRE-SHAPE LINER - FULL CUSTOM T2 |

RBJ1030 WHITE / 24 - 30.5



RACE TEXTILE



RACING JACKET

| | |
|---------|--|
| RLJS01A | RACING JACKET ADULT S / M / L / XL / XXL |
| RLJS01J | RACING JACKET JUNIOR 008 / 010 / 012 / 014 years |

RACING PANT

| | |
|---------|--|
| RLJS03A | RACING PANT ADULT S / M / L / XL / XXL |
| RLJS03J | RACING PANT JUNIOR 008 / 010 / 012 / 014 years |

RACING SHORT

| | |
|---------|---|
| RLJS02A | RACING SHORT ADULT S / M / L / XL / XXL |
| RLJS02J | RACING SHORT JUNIOR 008 / 010 / 012 / 014 years |



INNER JACKET

| | |
|---------|---|
| RLJS04A | INNER JACKET ADULT S / M / L / XL / XXL |
| RLJS04J | INNER JACKET JUNIOR 008 / 010 / 012 / 014 years |



GIANT SUIT

| | |
|---------|---|
| RLJS06A | GIANT SUIT (ADULT) S / M / L / XL / XXL |
| RLJS06J | GIANT SUIT (JUNIOR) 012 / 014 years |



JUNIOR PANT

| | |
|---------|-----------------------------|
| RLIYP06 | 008 / 010 / 012 / 014 / 016 |
|---------|-----------------------------|



WC MASTER LTH IMPR G



| | |
|---------|----------------------------|
| RLIMG10 | XS / S / M / L / XL / 2 XL |
|---------|----------------------------|



WC MASTER LTH IMPR LOBSTER



| | |
|---------|----------------------------|
| RLIMG13 | XS / S / M / L / XL / 2 XL |
|---------|----------------------------|



HERO CAP X3

| | |
|---------|----------|
| RLJMH14 | ONE SIZE |
|---------|----------|

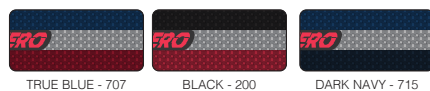

HERO HB X3

| | |
|---------|----------|
| RLJMH01 | ONE SIZE |
|---------|----------|

ROSSIGNOL RACE DEPARTMENT RECOMMENDATIONS (Skis, Bindings, Skiboosts)

General Observations: Ski selection, both model and length, always will be a very personal and, to a large degree, a very subjective decision. The following chart shows some of the common trends we noticed as a result of our ongoing testing, which should be taken into consideration when making model and length decision. Optimal ski length is determined by the following order: ability, weight and strength. The Rossignol Race Department hopes you will find this information useful and wishes you an excellent winter of racing. Good luck at the races!

| U8 | Weight (lbs) | Weight (kg) | Multi-Event Multi-Evenement | Size (cm) | Size (cm) RACERS CONFIRMED | | Bindings Fixations | Boots Chaussures | |
|------------------------------------|--------------|-------------|---|--|----------------------------------|---|---|--|------------------------|
| | Poids (lbs) | Poids (kg) | | LEARNING Taille (cm) APPRENTISSAGE | Taille (cm) RACERS CONFIRMER | | | | |
| AGE 6-7 BIRTH YEAR 2014/2015 | 40-50 | 18-23 | HERO JUNIOR MULTI -EVENT | | 110 | | TEAM 4 | HERO Jr 65 | |
| | 50-60 | 23-27 | | | 120 | | TEAM 4 / NX JR 7 | | |
| | 60-70 | 27-32 | HERO ATHLETE MULTI -EVENT | | 127 | | NX JR 7 | | |
| | 70-80 | 32-36 | | | 134/141 | | | | |
| U10 | 50-60 | 23-27 | HERO JUNIOR MULTI -EVENT | | 120 | | TEAM 4 / NX JR 7 | HERO Jr 65 | |
| | 60-70 | 27-32 | | | 130 | | | | |
| | 70-80 | 32-36 | HERO ATHLETE MULTI -EVENT | | 127/134 | | NX JR 7 LITFER | | |
| | 80-90 | 36-41 | | | 141/148 | | | | |
| U12 | 60-70 | 27-32 | HERO ATHLETE GS PRO (R21 PRO) | Size (cm) Taille (cm) | SL | Size (cm) Taille (cm) | Bindings Fixations | Boots Chaussures | |
| | 70-80 | 32-36 | | 135 | HERO ATHLETE SL PRO (R21 PRO) | 128 | NX JR 7 | HERO Jr 65 | |
| | 80-90 | 36-41 | | 144 | | 135 | NX JR 7 / NX JR 10 | HERO WC SI 70 SC | |
| | 90-100 | 41-45 | | 151 | | 135 / 142 | NX JR 10 / SPX 10 (Green LTD or Black Icon) | | |
| | 100-110 | 45-50 | | 158 | | 142 | | | HERO WC SI 90 SC |
| | | | | 165 | | 149 | | | |
| U14 | 70-80 | 32-36 | HERO ATHLETE GS PRO (R21 PRO) | 144 | | HERO ATHLETE SL PRO (R21 PRO & R22 (150 only)) | 135 | NX JR 7 / NX JR 10 | HERO Jr 65 |
| | 80-90 | 36-41 | | 151 | 135/142 | | NX JR 10 / SPX 10 (Green LTD or Black Icon) | HERO WC SI 70 SC | |
| | 90-100 | 41-45 | | 158 | 142 | | SPX 12 Rockerace (GS) / SPX 10 (SL) (Green LTD or Black Icon) | HERO WC SI 90 SC | |
| | 100-110 | 45-50 | 165 | 149 | | | | | |
| | 110-120 | 50-54 | HERO ATHLETE GS PRO (R22) | 170 | 149/150 | | | | |
| U16 | 90-100 | 41-45 | HERO ATHLETE GS PRO (R22)** | 165 | HERO ATHLETE SL PRO (R21 PRO) | 142 | SPX 12 Rockerace (GS) / SPX 10 (SL) (Green LTD or Black Icon) | HERO WC SI 70 / 90 SC | |
| | 100-110 | 45-50 | HERO ATHLETE GS (R22) | 170 | | 149 | | | HERO WC SI 90 / 110 SC |
| | 110-120 | 50-54 | | 175 | HERO ATHLETE SL (R22) | 150 | SPX 12 Rockerace (Green LTD or Black Icon) | HERO WC SI 110 SC / Z J+ | |
| | 120-130 | 54-59 | | 182 | HERO ATHLETE FIS SL (R22) | 157 | | | |
| | 130-150 & + | 59-68 & + | | 182/185* | | 157/165 | SPX 12 Rockerace / SPX 15 Rockerace (Green LTD or Black Icon) | | |
| U18 U21 U30 FIS WOMEN | 100-110 | 45-50 | HERO ATHLETE FIS GS (R22) | 188 | HERO ATHLETE FIS SL (R22) | 157 | SPX 12 Rockerace (Green LTD or Black Icon) | HERO WC SI 110 SC | |
| | 110-120 | 50-54 | | | | | | HERO WC SI Z J+ | |
| | 120-130 | 54-59 | | | | | | SPX 15 Rockerace (Green LTD or Black Icon) | HERO WC SI ZA Or ZA+ |
| | 130-140 | 59-63,5 | | | | | | | |
| | 140-150 | 63,5-68 | | | | | | | |
| | 150-160 | 68-73 | | | | | | | |
| | 160-170 & + | 73-77 & + | | | | | | | |
| U18 U21 U30 FIS MEN | 100-110 | 45-50 | HERO ATHLETE FIS GS (R22)/ HERO ATHLETE FIS GS DLC (R22) | 188 | HERO ATHLETE FIS SL (R22) | 157 | SPX 15 Rockerace (Green LTD or Black Icon) | HERO WC SI Z J+ | |
| | 110-120 | 50-54 | | | | | | | HERO WC SI ZA Or ZA+ |
| | 120-130 | 54-59 | HERO ATHLETE FIS GS FACTORY (R22) | 193 | | 167 | SPX 15 Rockerace (Green LTD or Black Icon) | HERO WC SI ZA Or ZA+ | |
| | 130-140 | 59-63,5 | | | | | | | |
| | 140-150 | 63,5-68 | | | | | | | |
| | 150-160 | 68-73 | | | | | | PX 18 WC Rockerace (Green LTD or Black Icon) | HERO WC SI ZA/ZB |
| | 160-170 | 73-77 | | | | | | | |
| | 170 & + | 77 & + | | | | | | | |

* Size 185cm could be use for Adultes race, non FIS ! But also for U16 FIS Race

* La taille 185cm peut être utilisé pour des courses Adultes non FIS mais aussi par des U16 en FIS.

**Second Year U16 Boys should consider use of 188 or 193, 30m GS skis based on coaches discretion.

**Les coureurs en deuxième année U16 devraient considérer les tailles 188 ou 193 (ski de GS avec rayon de 30m) à la discrétion de leur entraîneur.

FIS Rules > www.fis-ski.com



Follow us on



facebook.com/SkiRacingCommunity

SKIS ROSSIGNOL S.A.S.

Société par Actions Simplifiée

Registered Capital 71.746.248 EUR

HQ: 98 rue Louis BARRAN - 38430 ST JEAN DE MOIRANS (France)

Company registration: 056 502 958 RCS Grenoble

Rossignol reserves the right to modify the models shown in this document without prior notice.

© Photos: Agence Zoom